

JGA[®]

CONVENTIONAL PRESSURE AND SUCTION FEED

Updated Technology!



DEVILBISS[®]

- **World famous JGA fit, feel, and balance**
- **Superior atomization** – Newest #9000 air cap designed for today's refinishing materials. Provides uniform film build for maximum control of brightness with metallics
- **Stainless steel fluid tip and needle**
- **Maximum durability** – drop-forged aluminum gun body
- **Replaceable threaded baffle for economical servicing**
- **Cartridge type air valve for positive sealing and quick action**
- **Updated Technology! Simple, economical servicing** – air caps, fluid tips and needles available separately
- **For two-quart pressure feed outfit, order –**
JGA Pressure Feed Gun (see selection lower left corner)
Two quart remote cup (120033/KB-555)
6' air and fluid hose assembly (220019/KB-4006)
- **Suction feed guns also include:**
TGC 1-quart suction feed cup (120011/TGC-545)

JGA Pressure Feed

The adjustable JGA Pressure Feed Outfit allows the operator maximum flexibility in spray finishing applications. Pressure feed is ideal for spraying large surfaces without having to stop often to refill a gravity or suction feed cup.

Separate atomization air and fluid pressure adjustments are possible when using a KB pressure cup, with a regulator on the gun or at the booth, making the JGA Pressure Feed Gun truly user friendly.

JGA Suction Feed

The JGA suction feed gun combines the world famous JGA fit, feel, and balance with a traditional suction feed material supply system. This allows painters who are not yet using gravity feed to spray with the method they are used to.

| Order No. Model No. | Fluid Tip (mm) | Inlet Pressure (CFM) | Applications |
|--------------------------|-------------------|--------------------------|--|
| JGA Pressure Feed | | | |
| 110271 JGA-504-765-12 | 1.2 | 60-65 psi (19-22 cfm) | High solids fleet materials, up to 13 oz./min. fluid flow |
| 110274 JGA-504-777-14 | 1.4 | 50-80 psi (17-25 cfm) | High solids fleet materials, greater than 13 oz./min. fluid flow |
| 110273 JGA-504-90-12 | 1.2 | 35-50 psi (9-13 cfm) | Low to medium solids less than 10 oz./min. fluid flow |

JGA Suction Feed

| | | | |
|-------------------|-----|--------------------------|---|
| 110225 JGA-644 | 1.6 | 35-50 psi (9-13 cfm) | Base, clear, low VOC, single stage, urethanes. Includes #9000 air cap and TGC cup. |
| 110102 JGA-636 | 1.8 | 25-45 psi (10-14 cfm) | Synthetic and acrylic enamels. May need to restrict fluid flow with needle adj. For base and clear coats. Includes #80 air cap & TGC cup. |

JGA® Pressure/Suction Feed

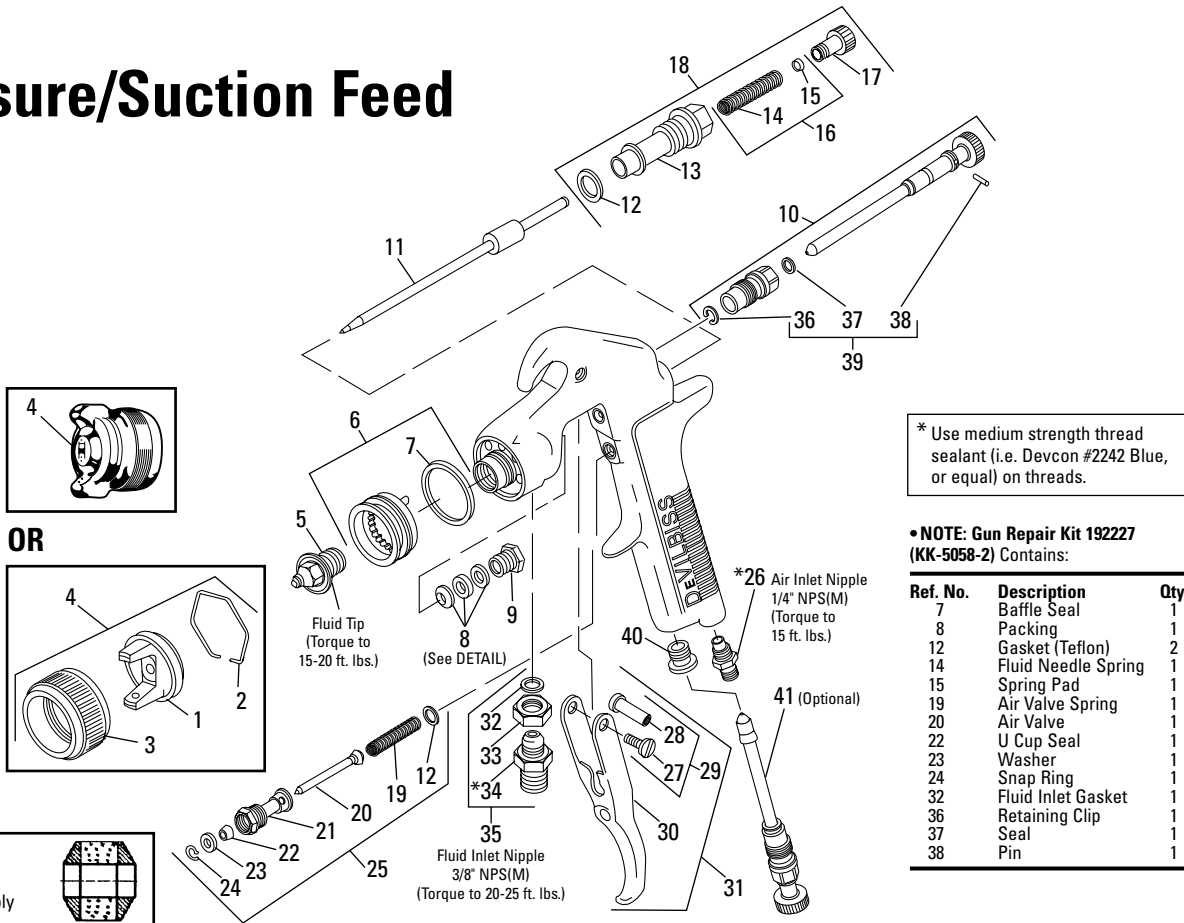

* Use medium strength thread sealant (i.e. Devcon #2242 Blue, or equal) on threads.

•NOTE: Gun Repair Kit 192227 (KK-5058-2) Contains:

| Ref. No. | Description | Qty. |
|----------|---------------------|------|
| 7 | Baffle Seal | 1 |
| 8 | Packing | 1 |
| 12 | Gasket (Teflon) | 2 |
| 14 | Fluid Needle Spring | 1 |
| 15 | Spring Pad | 1 |
| 19 | Air Valve Spring | 1 |
| 20 | Air Valve | 1 |
| 22 | U Cup Seal | 1 |
| 23 | Washer | 1 |
| 24 | Snap Ring | 1 |
| 32 | Fluid Inlet Gasket | 1 |
| 36 | Retaining Clip | 1 |
| 37 | Seal | 1 |
| 38 | Pin | 1 |

DETAIL #8
3-Piece Needle Packing Assembly

| Ref. No. | Order No. | Model No. | Description | Ind. Parts Required |
|----------|-----------|------------------|--|---------------------|
| 1 | — | — | Air Cap | 1 |
| 2 | 191972 | JGA-156-K10 | Spring Clip (Kit of 10) | 1 |
| 3 | 192042 | GTI-3 | Air Cap Retaining Ring | 1 |
| 4 | — | See Chart 1 | Air Cap & Retaining Ring | 1 |
| 5 | — | See Charts 1 & 2 | Fluid Tip | 1 |
| 6 | 192178 | GTI-425 | Baffle Assembly | 1 |
| •7 | 192179 | GTI-33-K5 | Baffle Seal (Kit of 5) | 1 |
| •8 | 192109 | JGA-4035-K5 | Packing (Kit of 5) | 1 |
| 9 | 190893 | 34411-122-K10 | Packing Nut (Kit of 10) | 1 |
| 10 | 192051 | GTI-405 | Spreader Valve Assembly | 1 |
| 11 | — | See Chart 1 | Fluid Needle | 1 |
| •12 | 190161 | JGS-72-K10 | Gasket (Teflon) (Kit of 10) | 2 |
| 13 | — | — | Body Bushing | 1 |
| •14 | — | — | Fluid Needle Spring | 1 |
| •15 | — | — | Spring Pad | 1 |
| 16 | 190894 | MBD-19-K10 | Spring & Pad (Kit of 10) | 1 |
| 17 | 192043 | GTI-414 | Needle Adjusting Screw | 1 |
| 18 | 192139 | KK-5059 | Bushing, Spring, Pad & Knob Kit | 1 |
| •19 | — | — | Air Valve Spring | 1 |
| •20 | — | — | Air Valve | 1 |
| 21 | — | — | Air Valve Body | 1 |
| •22 | — | — | U Cup Seal | 1 |
| •23 | — | — | Washer | 1 |
| •24 | — | — | Snap Ring | 1 |
| 25 | 190780 | JGS-449-1 | Air Valve Assembly | 1 |
| 26 | 190287 | P-MB-51 | Air Inlet Nipple 1/4" NPS(M) | 1 |
| 27 | — | — | Trigger Stud Screw | 1 |
| 28 | — | — | Trigger Stud | 1 |
| 29 | 190889 | JGS-478 | Stud & Screw Kit (Kit includes 3 Studs & 5 Screws) | 1 |
| 30 | — | — | Trigger | 1 |
| 31 | 191943 | JGS-477-1 | Trigger, Stud & Screw Kit | 1 |
| •32 | — | — | Fluid Inlet Gasket (Teflon) | 1 |
| 33 | — | — | Locknut | 1 |
| 34 | — | — | Fluid Inlet Adapter | 1 |
| 35 | 190888 | JGA-4042 | Fluid Inlet, Gasket & Nut Kit | 1 |
| •36 | — | — | Retaining Clip | 1 |
| •37 | — | — | Seal | 1 |
| •38 | — | — | Pin | 1 |
| 39 | 192229 | GTI-428-K5 | Clip, Seal & Pin Kit (5 Each) | 1 |
| 40 | 190828 | JGA-132 | Plug | 1 |
| 41 | 192228 | GTI-415 | Air Adjusting Valve (Optional) | 1 |

CHART 1 – AIR CAPS, FLUID TIPS, FLUID NEEDLES & APPLICATIONS

| No. on Air Cap Order No. → | Air Cap With Ring (Ref. No. 4) | Type of Fluid Delivery | Suction Feed | | Pressure Feed | |
|----------------------------|--------------------------------|---------------------------|----------------------------|------------------------------|----------------------------|------------------------------|
| | | | Fluid Needle (Ref. No. 11) | Fluid Tips Used (Ref. No. 5) | Fluid Needle (Ref. No. 11) | Fluid Tips Used (Ref. No. 5) |
| 80 | 190230 MB-4039-80 | SUCTION | 192054 GTI-413 | AV-213-16 OR AV-213-18 | | |
| 9000 | 199000 AV-440-9000 | SUCTION OR PRESSURE | 192054 GTI-413 | AV-213-16 OR AV-213-18 | 192311 GTI-449-12 | AV-213-10 OR AV-213-12 |
| 765 | 192310 AV-440-765 | PRESSURE | | | 192311 GTI-449-12 | AV-213-12 |
| 777 | 192066 AV-440-777 | PRESSURE | | | 192311 GTI-449-12 | AV-213-14 |

CHART 2 – FLUID TIPS

| Fluid Tip Order No. | Fluid Tip Model No. | Tip Size (in.) | I.D. (mm) | Type of Fluid Delivery |
|---------------------|---------------------|----------------|-----------|------------------------|
| 192215 | AV-213-10 | .039 | 1.0 | Pressure Feed |
| 192168 | AV-213-12 | .047 | 1.2 | Pressure Feed |
| 192170 | AV-213-14 | .055 | 1.4 | Pressure Feed |
| 192172 | AV-213-16 | .063 | 1.6 | Suction Feed |
| 192173 | AV-213-18 | .070 | 1.8 | Suction Feed |

NOTE: See Section G-2 for TGC-545 Suction Feed Cup parts breakdown.

• A quantity of necessary parts is included in 192227 Repair Kit (KK-5058-2) for complete gun repair and should be kept on hand for service convenience.

Suffixes: -K5 designates kit of multiple parts. Example: JGA-4035-K5 is a kit of 5 packings.



ITW Automotive Refinishing
An Illinois Tool Works Company
1724 Indian Wood Circle, Suite J-K
Maumee, OH 43537-4048
Telephone 419-891-8100
Fax 419-891-8110
www.devilbiss.com

